

High School Development Project



THE FLEISCHER
FOUNDATION
-KENYA-



We seek to promote the personal development and empowerment of underprivileged children in developing countries through mentorship and education.





Access to education and mentorship opportunities

About Us

The Foundation is a registered 501(c)(3) not-for-profit incorporated in both the United States and Kenya. It was established because of the terrible truth that children from slum environments do not have the financial resources to possibly attend high school.

The Foundation has created an interview process to locate the best & brightest from these slum environments. Once found, the Foundation provides all that is required so these children can attend high school and afterwards, university. The Foundations first attempt at breaking this cycle of poverty began with the children from the Mukuru Kwa Njenga slum just outside Nairobi, Kenya.



The Project

The Fleischer Foundation, committed to the **students it has sponsored**, has embarked on **building its very own secondary school**. This school will offer the **children** we support a better **PATH TO SUCCESS**.

Currently, the Foundation provides **full scholarships** to send its **selected students** to public schools throughout Kenya. Because these schools are only **partially subsidized by the Government**, most do not offer the quality of education desired.

This **HIGH SCHOOL** will **offer our children** the kind of **education** usually only reserved for the most affluent of Nairobi.



Why Build a High School

Change happens first with one child, then with one family, and then with one community. This has been our goal from the start – to change the slum environments in Kenya - one child at a time.

The Fleischer Foundation plans to realize this vision by creating a secondary school that empowers these children, and that offers an education that they deserve.

This brochure presents to you the funds needed to realize this vision.

CHILDREN BENEFIT FROM

- Non-selective admission to a culturally diverse learning environment
- Cutting-edge teaching programmes using latest IT technology
- Highly structured, hi-tech, interactive and engaging lessons
- Weekly individual student tracking through progress assessments
- Comprehensive, integrated enrichment programme to develop life skills
- Outstanding exam results and progression to top universities



The Location

The development is roughly 15 miles from the Karen suburb of Nairobi, Kenya and only 3 miles from the nearest town. It overlooks the beautiful Ngong Hills and offers a quiet & rural area perfect for a school. The development is located in Kajiado County – home to the famous Masai Tribe of Kenya.



Master-Plan



KEY

- 1. GATE HOUSES
- 2. GENSET
- 3. SERVICE YARD PARKING
- 4. BUS PARKING
- 5. BASKETBALL COURT
- 6. ADMINISTRATION BLOCK
- 7. KITCHEN
- 8. DINING HALL
- 9. PLAY AREA
- 10. LIBRARY
- 11. WASHROOMS
- 12. CLASSROOMS
- 13. PLAYING FIELD
- 14. DORMITORIES
- 14. STAFF RESIDENCE
- 15. SHAMBA
- 16. STAFF RESIDENCE
- 17. GATE HOUSE



Corporate Sponsors

We are fortunate to have connected with multiple companies who share our vision for this school project and the impact it can have on the underprivileged children of Nairobi, Kenya. Thanks to their support, this project has already broken ground.



Local Partners in the Project

We have engaged multiple companies here in Kenya as partners to ensure that this school and project is completed properly. These companies have decided to support us through their Corporate Social Responsibilities programs.



Environmental Impact

In a world of an ever changing climate, we attempt to mitigate global warming wherever we can. To do this, the project will employ local materials and building technology that reduces the project's embodied energy.

- East West Orientation of building blocks
- Rain Water harvesting
- Ventilating courtyards
- Narrow plan buildings for cross ventiaition
- Light coloured finishes to reflect heat

30%
Total Savings
from energy



Sustainable Technology



Solar Water Heating



Energy Efficient LED Lighting



Solar Panels



Rain Water Harvesting



Biodigester



Motion Sensing Lighting

Project Cost



Classrooms

\$28,300 USD PER CLASSROOM



Dining Hall

\$46,000 USD



Labs

\$28,300 USD PER LAB



Dorms

\$62,100 USD PER DORM



Administration Block

\$37,100 USD



Basketball Court

\$44,000 USD



Soccer Field

\$35,000 USD



Mentorship Center

\$86,300 USD



Library

\$80,000 USD

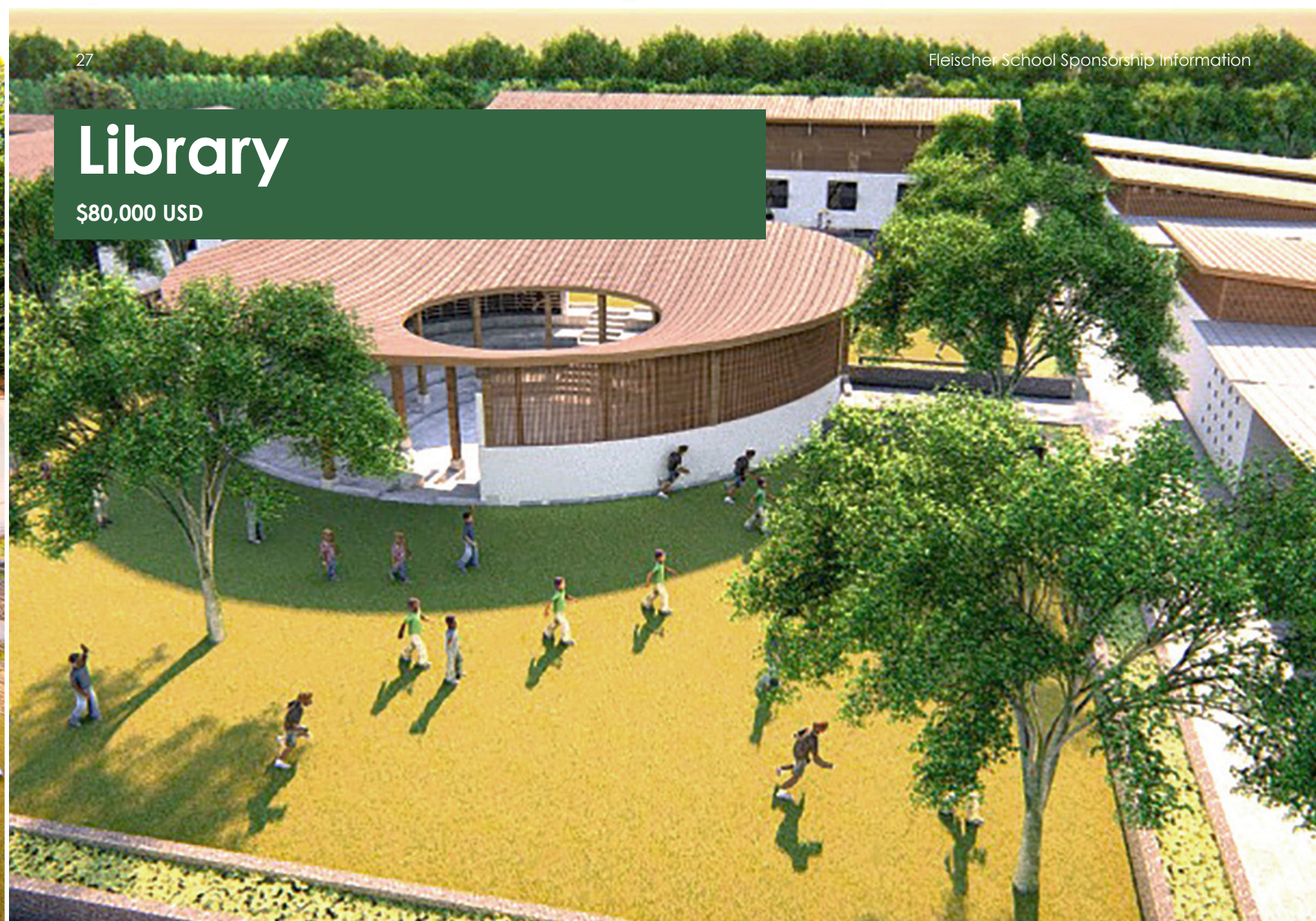

Sponsorship Journey

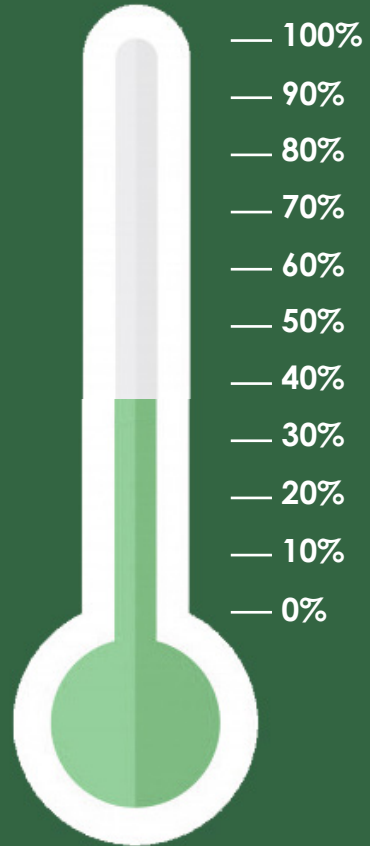

\$951,497 USD

Achieved

38%

of our goal reached

Make a Donation

If you would like to **contribute toward this project**, please consider reaching out to us directly or **visiting our website** at www.thefleischerfoundation.org



The **Fleischer Foundation** is a registered 501 (c) (3) **NON-PROFIT** making all contributions **tax deductible**.

Donate From USA



Donate From Kenya



How to donate:

- Online with a credit card through our website
- By mailing us a check
- Through a bank transfer

EIN: 81-4218767
NAICS: 813219
IC: 8399



Our Offices

The Fleischer Foundation
4334 N Hazel St, Suite 405
Chicago, IL 60613
United States of America

The Fleischer Foundation
Sanlam Tower, Off Waiyaki Way, 4th Floor
Nairobi, Kenya

info@thefleischerfoundation.org
+1-312-967-9426 (U.S.A.)
+254-798-981-033 (Kenya)



www.thefleischerfoundation.org